

MT907/D

Infra-red track marker receiver

Description

The MT907/D is an infra-red optical beacon receiver used in combination with the MT906/D IR binary coded sequence transmitters.

The MT907/D triggers a 5 V pulse only when the received matching team-code is recognised.

This IR beacon receiver is compatible with most of the Magneti Marelli data loggers, dashboards and ECUs, for which the end-of-lap reference is of the outmost importance.

An indicator LED on the back end of the receiver lights up when the transmitter code is detected.

Main Features

- IR optical receiver
- Received team-code recognition
- LED for easy check-up and installation



Benefits

- Compatible with Magneti Marelli data loggers, dashboard and ECUs
- Compact, robust design

Typical Applications

MotoGP

Professional circuit and rally applications

Race motorcycle application

Touring car

LAP TRIGGER

MT907/D

Infra-red track marker receiver

Dimensions

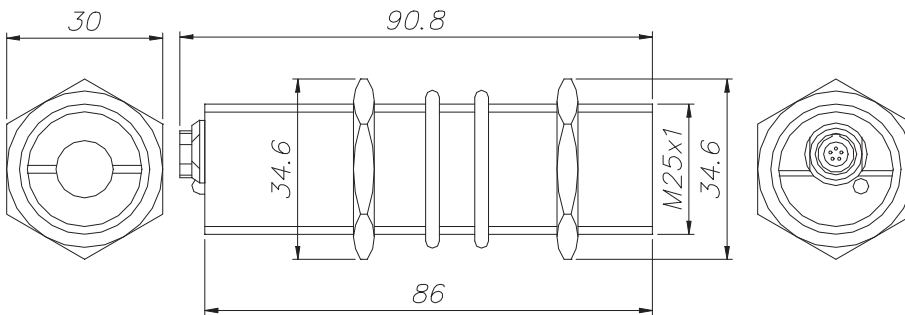

Dimensions in millimetres

Technical Characteristics

Range 1 to 25 m
Detection angle $\pm 37^\circ$
Code detect time 5 ms
Output
 sleep mode 0 V
 trigger 5 V
 duration 0.5 s
Red LED code detection indicator
Power supply (V DC) 10 to 15 V
Low battery warning lamp < 11 V
Current @ 13.2 V 50 mA
Protection polarity inversion
 short to GND & Vbatt
Ambient operating temperature -20 to 70 °C
Connector LEMO PHGOB305 5 pole
Container blue anodised aluminium
Cable length 330 mm
Dimensions (approx.) (see drawing) $\varnothing 25 \times 86$ mm
Weight (approx.) 60 g

Connector Pin Out

LEMO PHG0B305 5 pole		
Pin	Name	Description
1	VBAT	Power supply
2	ProgP	Reserved MM
3	ProgN	Reserved MM
4	GND	Ground
5	OUT	Signal

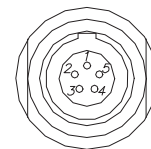

For further information, please contact:



October 2007
rel. 04
page 2 of 2