

ACTIVIDADES

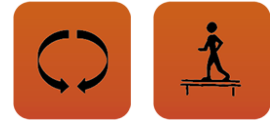

DATOS TÉCNICOS

DIMENSIONES:

Ø 0,70 x 1,15 m





SUPERFICIE DE JUEGO:

Ø 4,70 m

COMPONENTES:

Poste vertical y tubos estructurales en acero galvanizado. Elementos de unión de aluminio, y panel de aluminio

Accesibilidad:

		Motriz	<input checked="" type="checkbox"/>	<input checked="" type="checkbox"/>	<input type="checkbox"/>	<input type="checkbox"/>
		Sensorial	<input checked="" type="checkbox"/>	<input checked="" type="checkbox"/>	<input checked="" type="checkbox"/>	<input type="checkbox"/>
		Mental	<input checked="" type="checkbox"/>	<input checked="" type="checkbox"/>	<input checked="" type="checkbox"/>	<input type="checkbox"/>

INSTALACIÓN



Ø 0,70 x 2,10 m



98 kg / 98 kg



2 h / 2 operarios



De 4 a 14 años



3 usuarios

Revestimiento del suelo segun
norma EN-1176-1:2008

Ø 0,70

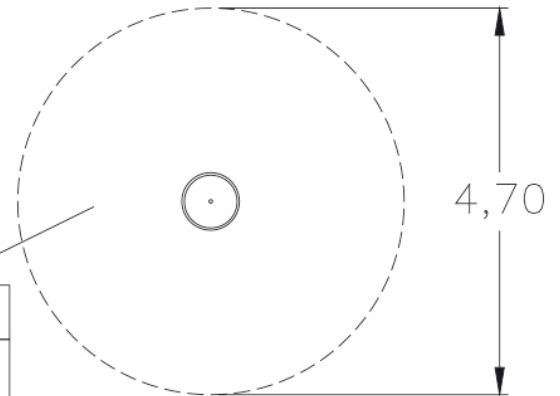
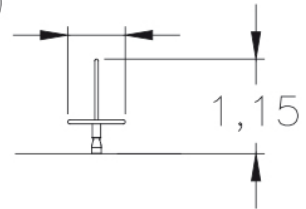

IMÁGENES

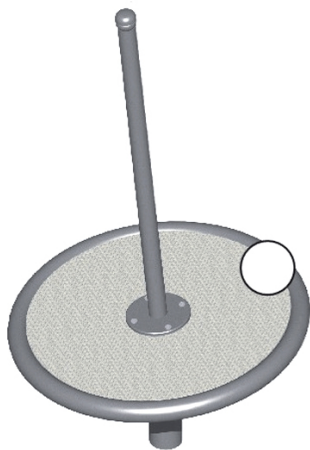

NORMA Y CERTIFICADOS:

